

**TYPE 'A'**

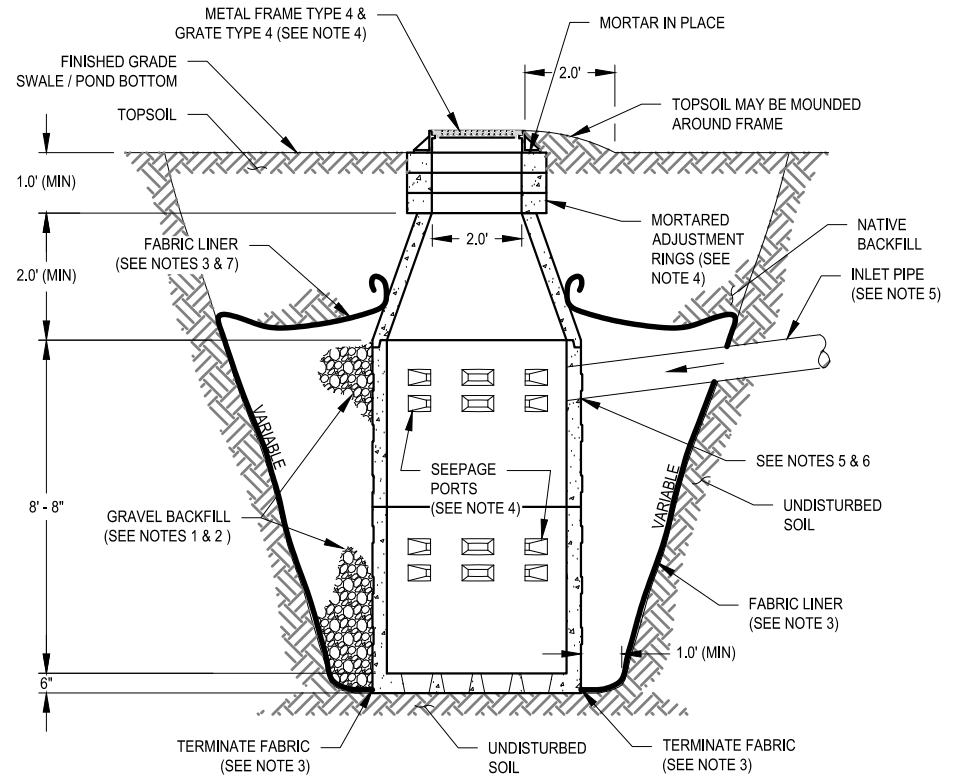

**TYPE 'B'**

## GENERAL NOTES:

- GRAVEL BACKFILL QUANTITY FOR DRYWELLS:  
TYPE "A" - 30 CUBIC YARDS MINIMUM / 42 TONS.  
TYPE "B" - 40 CUBIC YARDS MINIMUM / 56 TONS.  
OR AS SPECIFIED ON STREET PLANS.
- GRAVEL BACKFILL FOR DRYWELLS SHALL BE WASHED DRAIN ROCK CONFORMING TO WSDOT STANDARD SPEC. 9-03.12(5).
- FABRIC SHALL BE MODERATE SURVIVABILITY AS OUTLINED IN WSDOT STANDARD SPEC. 9-33.2(1). FABRIC SHALL NOT BE WRAPPED AROUND DRYWELL BARRELS OR PLACED ON THE BOTTOM OF THE BARREL.
- SEE PRECAST DRYWELL DETAILS, CITY STANDARD PLANS S-103 AND S-105. PRECAST MORTARED ADJUSTMENT RINGS SHALL BE USED IN LIEU OF ADJUSTING BLOCKS
- WHEN PVC PIPE IS USED, A SAND COLLAR SHALL BE INSTALLED.
- PIPES SHALL BE GROUTED INTO DRYWELL WITH WATERPROOF NON-SHRINK GROUT IN ACCORDANCE WITH STANDARD SPECIFICATION 9-20.3.
- GRAVEL BACKFILL TO BE COMPLETELY COVERED WITH FABRIC.

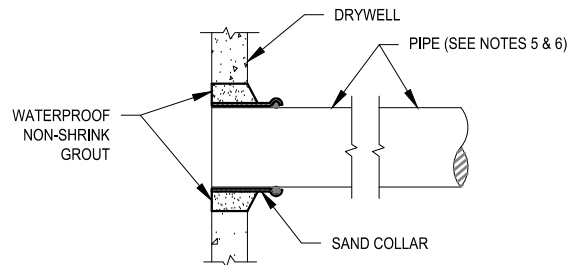

**PVC ADAPTER**



APPROVED BY:

*Robert B. Blegen*

ROBERT B. BLEGEN, P.E.  
PUBLIC WORKS DIRECTOR

**PRECAST DRYWELLS  
PLACED IN SWALE**

**STANDARD PLAN NO.  
S-101**

PUBLICATION DATE: 03/2025

REVISION NO.: 01